

Facades USA's UN8030 Curtain Wall System is an easy to install unitized system featuring varying depths and options to meet the needs of most projects.

- System Description:
  - Pre-assembled and Pre-glazed curtain wall system
  - System depth: 8 7/16" Captured, 7 11/16" SSG
  - Designed for 1" infills
  - Pressure-equalized system
  - Captured and SSG options
  - Polyamide thermal break design
- Performance Characteristics
  - Design loads: +/- 65 PSF (L/175 max)
  - Dynamic Water Infiltration: 15 PSF
  - Air Infiltration: 6.24 PSF (0.06 cfm/ft2 max)
  - Thermal transmittance : U-factor 0.28 tested
  - Superior wind load resistance
  - Maximum allowable deflection
- System Features
  - 2-1/2" to 3-1/2" sight line range
  - Adjustable slab edge anchoring
  - No exterior-applied joint seals
  - Exterior re-glazing capability
  - 90° inside and outside corners
  - Concealed fastener joinery
- Optional Features
  - Interior trim options
  - Steel mullion reinforcement
  - Integrated vent and entrance systems
  - Custom finishes

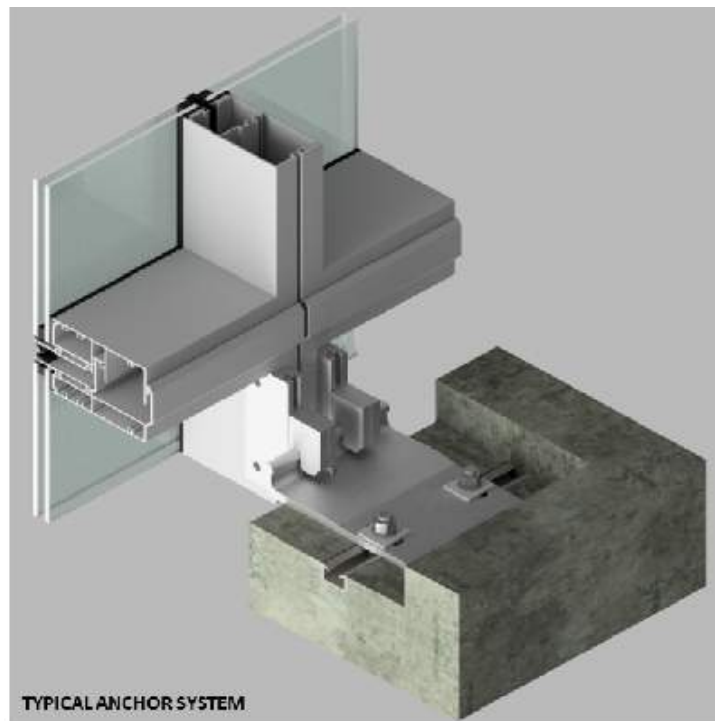

## Standard Details

